

Electric towing tractor 50.0 ton

Simai

Four wheel-series

TE501



Electric towing tractor 50.0 ton

Truck specifications					TE501
Identification	1.1	Manufacturer			Simai S.p.A
	1.2	Model			TE501
	1.3	Drive			Electric
	1.4	Operator type			Sit-on
	1.5	Load capacity/rated load ¹⁾	Q	kg	50000
	1.7	Rated drawbar pull	F	N	10000
	1.9	Wheelbase	y	mm	2025
Weight	2.1	Service weight		kg	5700
	2.2	Axle load, with load, front/rear		kg	2570 / 3490
	2.3	Axle load, without load, front/rear		kg	2370 / 3330
Wheels	3.1	Tyre - Cushion(Cu), Extra-elastic(SE), Pneumatic(Pn),Polyurethane			SE/Pn
	3.2	Wheel size, front			6.50-10
	3.3	Wheel size, rear			250-15
	3.5	Wheels, number front/rear (x = driven wheels)			2/2x
	3.6	Track width, front	b ₁₀	mm	1115
	3.7	Track width, rear	b ₁₁	mm	1130
Dimensions	4.7	Height of cab	h ₆	mm	1900
	4.8	Seat height	h ₇	mm	890
	4.12	Coupling height	h ₁₀	mm	345 - 400 - 455 - 510 - 565
	4.13	Loading height, unloaded	h ₁₁	mm	1100
	4.16	Length of loading surface	l ₃	mm	1805
	4.17	Overhang	l ₅	mm	515
	4.18	Width of loading surface	b ₉	mm	1060
	4.19	Overall length	l ₁	mm	3523
	4.21	Overall width	b ₁	mm	1355
	4.32	Ground clearance, centre of wheelbase	m ₂	mm	190
	4.35	Turning radius	W _a	mm	3680
4.36	Internal turning radius	b ₁₃	mm	1515	
Performance data	5.1	Travel speed, with/without load		km/h	7 / 16
	5.6	Max. drawbar pull		N	29000
	5.7	Gradeability		%	See chart
	5.8	Max. gradeability loaded/unloaded		%	See chart
	5.10	Service / parking brake (I=Hydraulic E=Electromagnetic M=Mechanical)			I / I
	5.10.1	Type of service brake front/rear			Disk / mult. disks
Electric motor	6.1	Drive motor rating S2 60 min		kW	26
	6.3	Battery according to DIN 43531 / 35 / 36 A, B, C, no			43536 A
	6.4	Battery voltage, nominal capacity ²⁾	K ₅	V/Ah	80 / 930
	6.5	Battery weight		kg	2288
	6.6	Energy consumption according to EN 16796		kWh/h	15,07
Others	8.1	Electronics control			Inverter AC
	8.4	Sound level at driver's ear according to EN 12053		dB(A)	69

¹⁾ Loading surface capacity: 200 kg.

²⁾ Performances and weight are intended with 930 Ah battery.

As per VDI guidelines 2198, this datasheet applies to standard electric tractor / platform truck only.

Dimensions are not binding and can be changed in any moment. The performances must be intended for brand new machines, after having completed the running-in tested in San Donato Milanese factory in normal climatic conditions.

Performances and weight are to be intended with standard motors and battery and with superelastic tires.

Some data can vary according to different equipments.

Dimensional drawings

EXAMPLE OF GRAPH READING:

TOWED LOAD = 10 t

GRADIENT (i) = 4 %

DRAWBALL PUL (F) = 10000 N

SPEED (V0) = 8 km/h

MAX. PRACTIBLE RAMP LENGTH (s) = 9,5 km

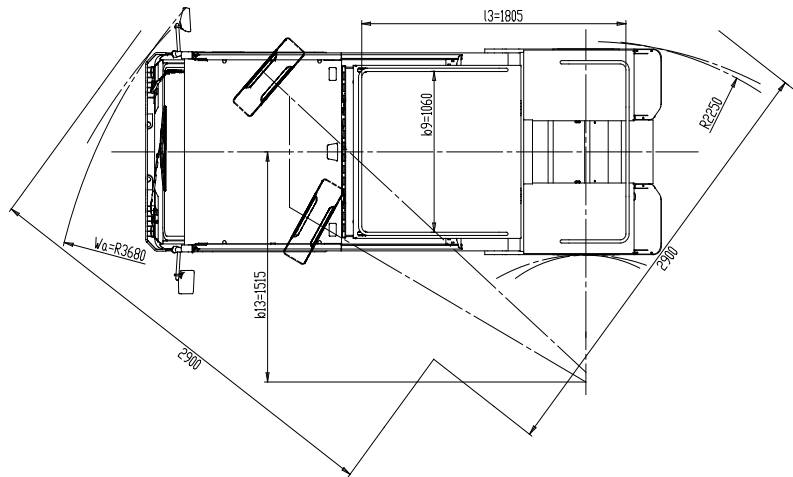
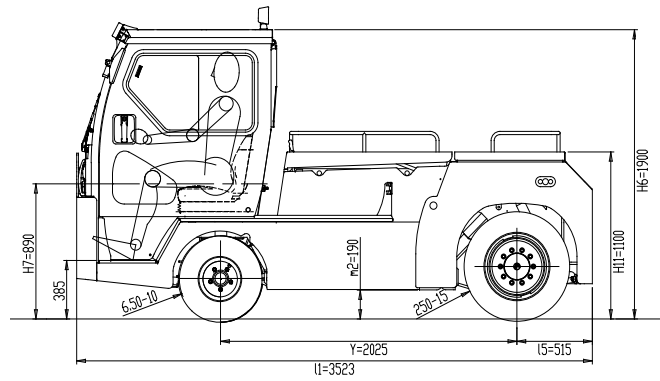
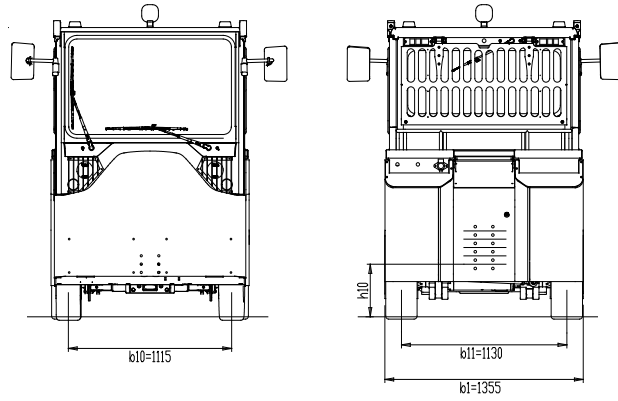
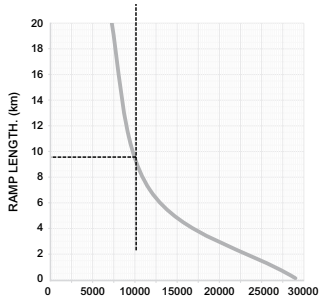
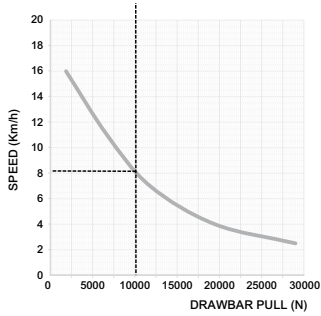
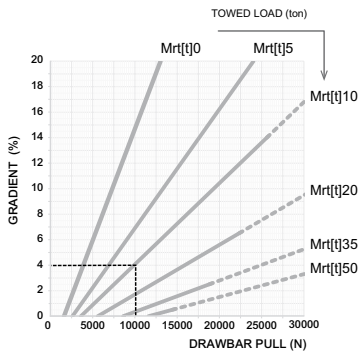

Standard equipments:

- Inching buttons
- Hydraulic steering
- AC power system
- High-thickness polyethylene bumpers in front and rear
- Brakes on all four wheels
- Adjustable steering column
- Rear motion buzzer
- Rear platform with 200 kg capacity
- Digital display
- Digital dashboard including battery charge level pilot, trouble shooting check system, speedometer, odometer and hourcounter

